

CW-B1600

| REV | DOCUMENT | CHANGED BY | CHECK |
|-----|----------|--------------|-------|
| 6 | 0041135 | VS 26 JUN 08 | BLR |

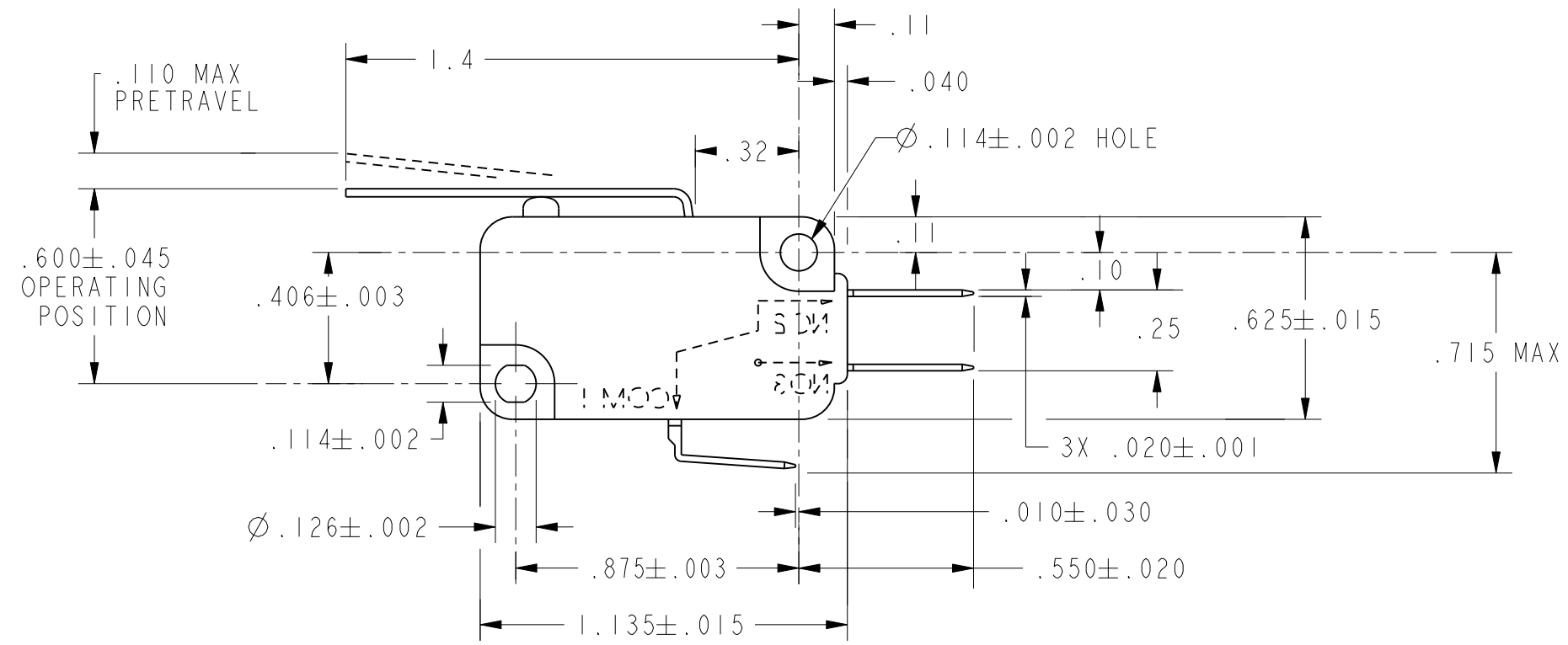
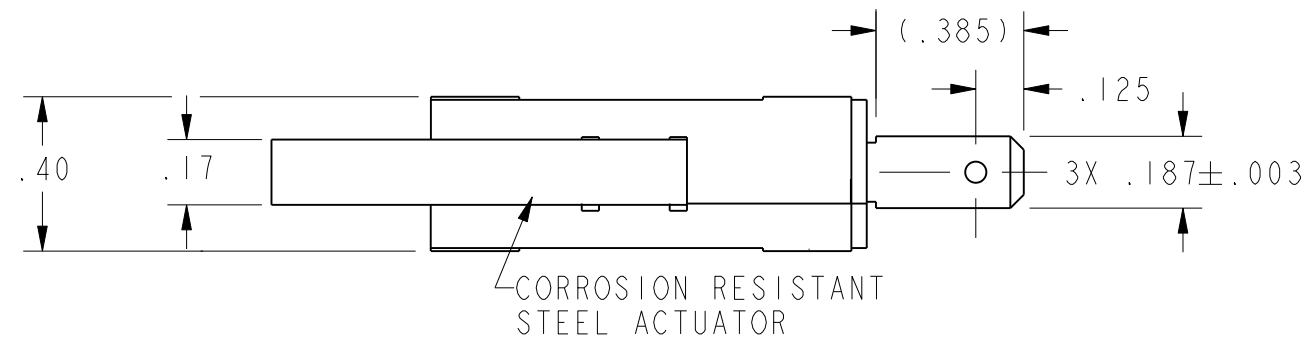

| CHARACTERISTICS | |
|--------------------------|--------------|
| OPERATING FORCE----- | 80 GRAMS MAX |
| RELEASE FORCE----- | 8 GRAMS MIN |
| DIFFERENTIAL TRAVEL----- | .030 MAX |
| OVERTRAVEL----- | .090 MIN |
| RELEASE TRAVEL----- | .017 MIN |

| ELECTRICAL DATA | |
|---------------------------------|--|
| CONTACT ARRANGEMENT | |
| S P D T | |
| L215 | |
| 15.1A 1/2HP 125, 250 OR 277 VAC | |
| 1/2A 125 VDC | |
| 1/4A 250 VDC; 5A 125 VAC "L" | |

UNLESS OTHERWISE SPECIFIED TOLERANCES ARE:

| | | |
|----------------------------------|---|---|
| | <input checked="" type="checkbox"/> US (inch) CUSTOMARY | <input type="checkbox"/> SI (mm) METRIC |
| NO PLACE | X ±.040 | ±1 |
| ONE PLACE | .X ±.030 | ±0,4 |
| TWO PLACE | .XX ±.015 | ±0,15 |
| THREE PLACE | .XXX ±.005 | ± |
| ANGLES | ± | ± |
| RAW MATERIAL-COMMERCIAL STANDARD | | |

THIRD ANGLE PROJECTION

| | | |
|--|------------------|---------|
| DRAWN | CSL | 07MAY03 |
| CHECK | SAV | 07MAY03 |
| THIS DRAWING COVERS A PROPRIETARY ITEM AND IS THE PROPERTY OF HONEYWELL. THIS DRAWING IS NOT TO BE COPIED OR USED WITHOUT THE PERMISSION OF HONEYWELL. | | |
| DIMENSIONS ARE TO BE MET BEFORE PROTECTIVE COATINGS ARE APPLIED | | |
| PTC 2D | ASME Y14.5M-1994 | |

| | | | |
|-------------------------------|----------|----------------------|--------------|
| Honeywell | | | |
| TITLE SWITCH, BASIC | | | |
| SIZE | DWG TYPE | DRAWING NAME | REV |
| B | I | V7-1C17D8-022 | 6 |
| SCALE | 2:1 | WEIGHT | SHEET 1 OF 1 |